

Plat Book MMM. Page 140

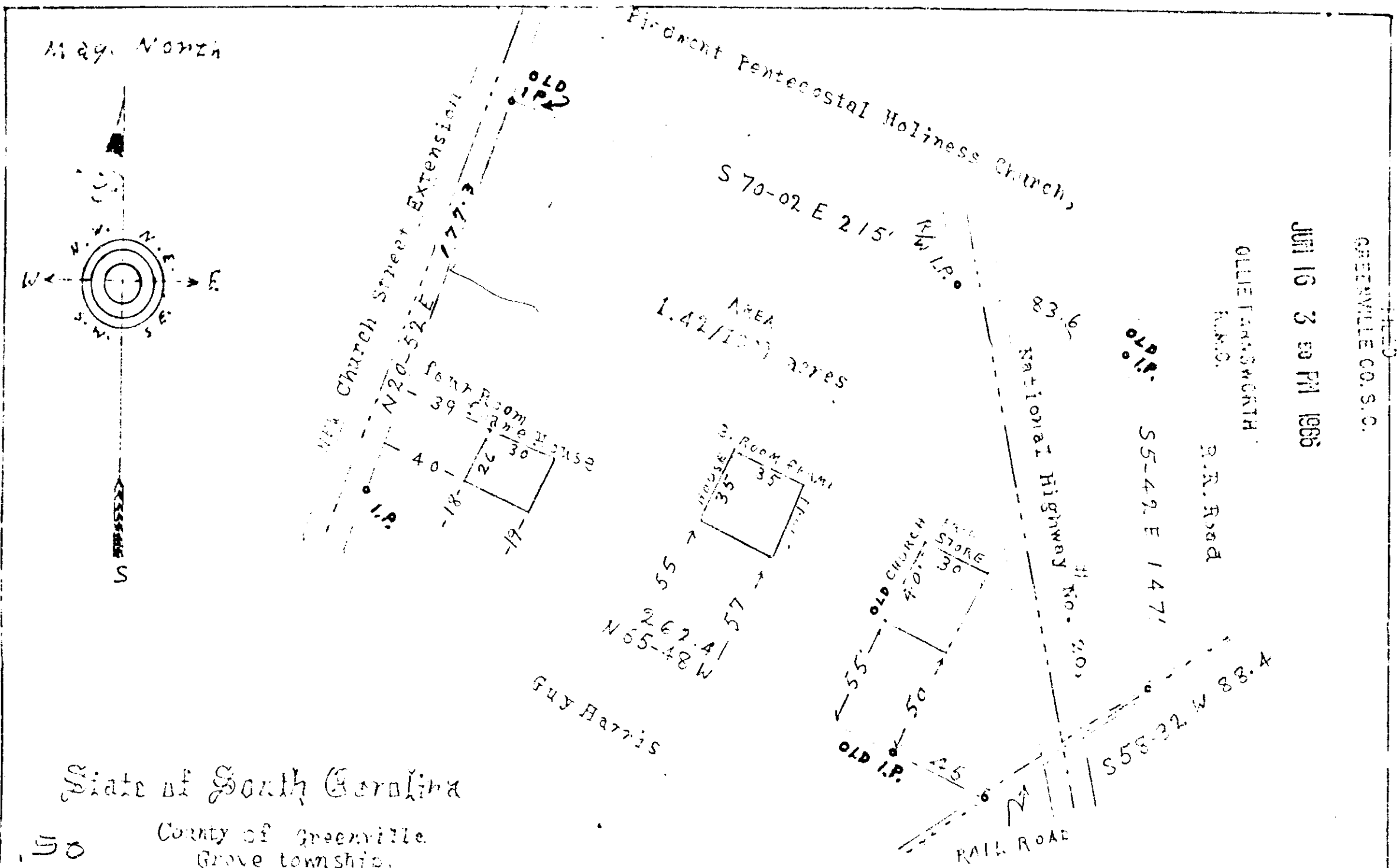

State of South Carolina

County of Greenville,
Grove township.

50
MMM - 140

Scale: one inch equals forty feet

35670

PROPERTY OF MRS. ETHEL MCCALL BECK LOCATED APPROXIMATELY ONE HALF MILE EAST OF PIEDMONT MILL ON S.C. HWY. NO. 20, THIS PLAT REPRESENTS THREE LOTS NO. 4, AND 5, AND PORTION SHOWN ON EAST SIDE OF HWY. NO. 20, LOTS NO. 4 AND 5, SHOWN ON PLATS MADE BY WM. F. LEE SURVEYOR DATED JAN. 5th 1899, SURVEYED MAY 7, 1966, BY REQUEST OF ETHEL MCCALL BECK FOR SALE TO DOT. JONES, TALMADGE C. COOPER and LLOYD G. JONES
by CHARLES R. DUNN and LOUISE C. FRANK L.S. REG. NO. 1578

35670 Filed This 16 day of June 1966

And Recorded in Vol. MMM Page 140 at 3:50 PM

Ollie Farnsworth
Register Mesne Conveyance Greenville County, S. C.